

THIS DRAWING IS UNPUBLISHED. RELEASED FOR PUBLICATION  
 © COPYRIGHT BY TYCO ELECTRONICS CORPORATION. ALL RIGHTS RESERVED.

LOC	DIST	REVISIONS					
G	86	P	LTR	DESCRIPTION	DATE	DWN	APVD
		N		REV PER ECR 08-004875	26FEB08	JR	MS

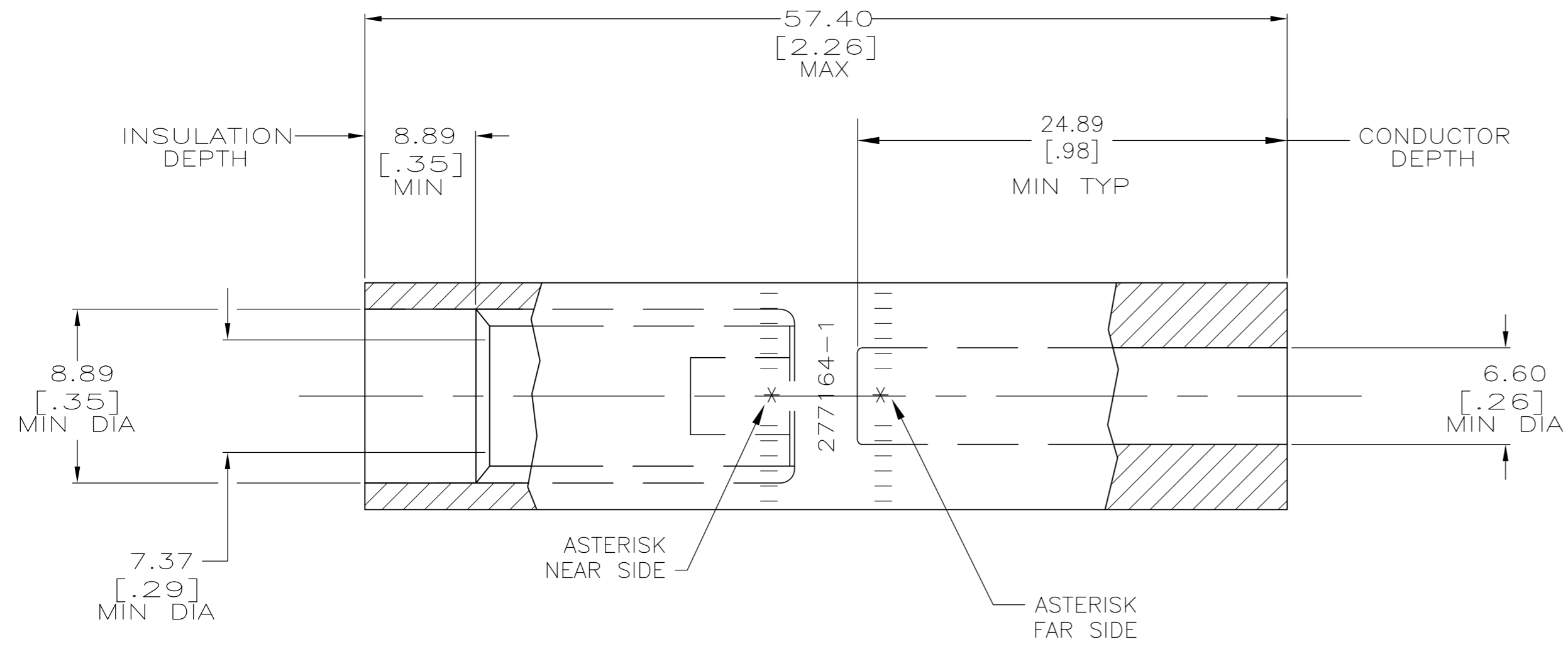

- 1 WIRE INSULATION:  
 END 'A' 7.01[.276] - 7.75[.305] DIA FOR 4 AL  
 END 'B' 5.33[.210] - 6.48[.255] DIA FOR 8 CU
- 2 STAMP " 277164-1 AMP 4AL-8CU"  
 LOCATED APPROX AS SHOWN

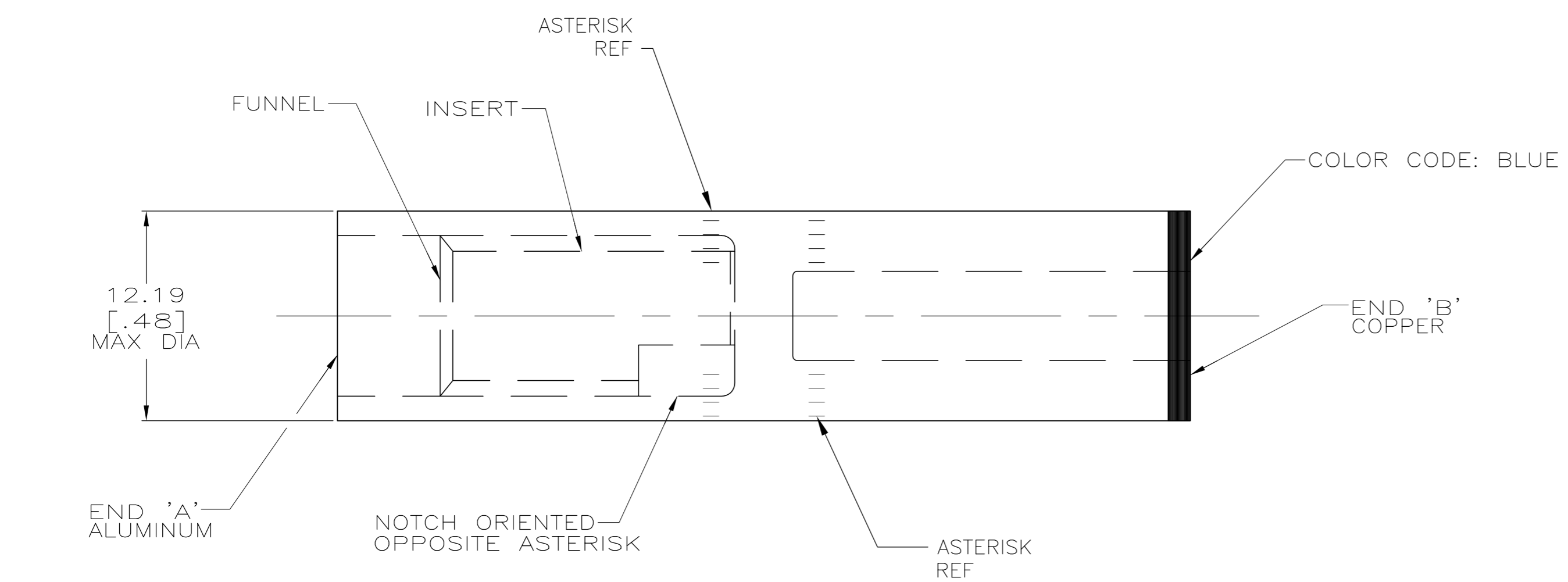

SPLICE: COPPER ASTM B-187 TIN PL PER ASTM B545, 0.00381[.000150] MIN THK INSERT & FUNNEL: BRASS ASTM B36 NICKEL PL SAE AMS QQ-N-290A, DATED JULY 2000, 0.00254 [.000100] MIN THK	277164-1
DESCRIPTION	PART NO.

THIS DRAWING IS A CONTROLLED DOCUMENT.		DWN DK SCHRUM 7/6/89	Tyco Electronics Corporation Harrisburg, Pa 17105-3608	
DIMENSIONS: mm [ INCHES ]		CHK MS FEHER 5/1/91	NAME	
TOLERANCES UNLESS OTHERWISE SPECIFIED:		APVD MJ SPICER 5/1/91	WIRE SPLICE, TRANSITIONAL, COPALUM, SEALED, WIRE SIZE : 21.9mm2 [4] ALUMINUM 8.8mm2 [8] COPPER	
0 PLC ± - 1 PLC ± - 2 PLC ± - 3 PLC ± - 4 PLC ± - ANGLES ± -		PRODUCT SPEC 108-11011-3	SIZE	DRAWING NO
MATERIAL SEE TABLE		FINISH SEE TABLE	WEIGHT 30.9 GRAMS	RESTRICTED TO
		CUSTOMER DRAWING		SCALE 4:1 SHEET 1 OF 1 REV N

277164